



OKLAHOMA  
Environmental  
Quality

# ENVIRONMENTAL COMPLAINTS AND LOCAL SERVICES DIVISION

## REPORT FOR ON-SITE SEWAGE TREATMENT SOIL PERCOLATION OR SOIL PROFILE TEST (PLEASE PRINT or TYPE)

Work Order No.

System No.

Date Rec'd

### GENERAL INFORMATION:

Name and Mailing Address of Property Owner: Housing Authority Cherokee Nations P.O. Box 1007 Tahlequah 74465  
First Name Last Name Mailing Address City Zip Code  
Owner Phone Number: Owner's E-Mail Address (Optional): Rueben Houston  
Property Address: 471746 E. 1060 Road Muldrow 74948 Sequoyah, Oklahoma  
Street Address City Zip Code County  
Legal Description: NE4 NW4 NE4 in Section 35, T12N, R25E Lot Size in ft<sup>2</sup> or 3 acres:  
Finding Location: At the intersection of E. 1060 Rd & S. 4715 Rd., go East on E. 1060 Rd. for .2 miles, house on right  
(Blocks or miles from a given point)  
Water Supply: ☐ Individual Private Well or ☒ Public Water Supply - Name: Sequoyah Co. RW Assoc  
GPS Coordinates: Lat: 35.47695 Long: -94.62468

### WATERBODY PROTECTION AREA:

Dispersal field located in Water Body Protection Area (check one): ☐ Zone 1 ☐ Zone 2 ☒ None

**Flow Certification:** 27A O.S. 2001, Section 2-6-403 states: "It shall be the duty of the person contracting with an installer who is modifying or installing an on-site sewage treatment system for a residence or business to certify the number of bedrooms in the residence or the water usage of the business that will be served by the sewage treatment system so that the system can be properly sized."

☒ This individual sewage treatment system will serve an individual residence or duplex with the following # of bedrooms 4  
☐ The estimated flow or actual flow for this small public sewage system is gal/day and is a

Type of Facility  
3/24/2025

Rueben

Houston

Rueben Houston

Date Signed

### SOIL TEST RESULTS:

Soil Profile Description						Soil Percolation Test Description		
Depth of Test Hole	HOLE #1		HOLE #2		HOLE #3		Shallowest Groundwater Depth	Overall Percolation Rate
	Group	Depth* to Limiting Layer†	Group	Depth* to Limiting Layer†	Group	Depth* to Limiting Layer†	inches	30 minutes/inches
0-6"								
6-12"								
12-18"								
18-24"								
24-30"								
30-36"								
36-42"								
42-48"								
48"-54"								
*Depth in inches (in.) †Limiting Layer: GW = Ground Water RX = Redox (must be 2 consecutive intervals) RC = Rock GS = Group 5 Soil								

### CERTIFIED SOIL TESTER USE ONLY:

I certify that I conducted the above-described soil profile description or percolation test in compliance with OAC 252:641 on 3/24/2025  
Date Test Performed

Email: okbigmig@yahoo.com

Soil Tester's Signature

P.O. Box 2038

Tahlequah

Address

City

State

Zip

Phone #

Date Signed

Brian

Miggleto

SP037 ES #1250

Please Print First Name

Last Name

Certification Number

OK

74465

918-822-7988

3/24/2025

\*This includes your Certification Number provided by DEQ or your Registration Number associated with your RPS, RPES, PE, LS, or SS.

### DEQ USE ONLY:

☐ Soil Test Performed by DEQ on (date):  
☐ DEQ Soil Profile Test ☐ Joint Soil Profile  
☐ DEQ Reviewed and Accepted  
☐ DEQ Reviewed and Rejected

Notes:

Environmental Specialist's Signature

Employee ID

Date Signed



SYSTEM DESIGN: Check all that apply.

**TREATMENT:**

☒ Septic Tank with 1,000 gal. liquid capacity ☐ Aerobic Treatment ☐ Aerobic Treatment with Nitrogen Reduction

**DISPERSAL:**

☒ CSA: soil group \_\_\_\_\_ or percolation rate of 30 (min/inch) with 510 feet of perforated pipe with storage media or 410 feet of manufactured media systems. The trench bottom shall be no deeper than 30 inches.

☐ SE: soil group \_\_\_\_\_ with \_\_\_\_\_ feet of subsurface absorption trenches. The trench bottom shall be no deeper than \_\_\_\_\_ inches.

☐ ET/A: soil group \_\_\_\_\_ with \_\_\_\_\_ feet of evapotranspiration trenches. The trench bottom shall be no deeper than \_\_\_\_\_ inches.

☐ L: with bottom dimensions of \_\_\_\_\_ feet by \_\_\_\_\_ feet or a diameter of \_\_\_\_\_ feet.

☐ DI: soil group \_\_\_\_\_ with a \_\_\_\_\_-gallon capacity pump tanks and \_\_\_\_\_ feet of drip line no deeper than \_\_\_\_\_ inches.

☐ SI: soil group \_\_\_\_\_ with a \_\_\_\_\_-gallon capacity pump tank and \_\_\_\_\_ square feet of surface application area.

☐ An Alternative system as described on the attached DEQ Form 641-581 Sup, "Supplemental Application for an Alternative System".

LOCATION OF TEST HOLES: Show the location of all test holes in relation to two fixed reference points in the sketch box below.

SKETCH BOX

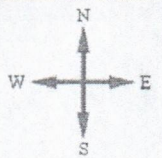
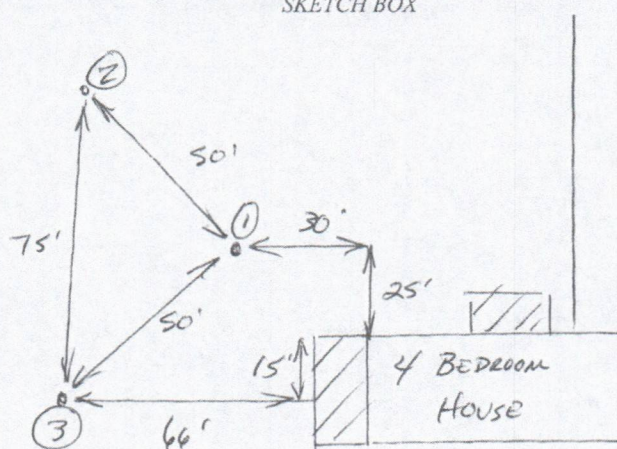

REMARKS: