

Map data ©2024 Google 2 mi

5014 S Muskogee Ave  
Tahlequah, OK 74464

**Continue to US-62 E/S Muskogee Ave**

28 sec (0.1 mi)

- ↑ 1. Head east
- ↶ 2. Turn left toward US-62 E/S Muskogee Ave

**Follow US-62 E to S 4677 Rd in Adair County**

33 min (23.2 mi)

- ↶ 3. Turn left onto US-62 E/S Muskogee Ave
- ↷ 4. Turn right onto US-62 E
- ↷ 5. Turn right to stay on US-62 E

**Take S 4695 Rd/N4686 Rd to E 761 Rd/D0761 Rd in West Peavine**

9 min (5.0 mi)

- ↷ 6. Turn right onto S 4677 Rd



Housing Authority of the Cherokee Nation  
 PO Box 1007,  
 Tahlequah, Oklahoma 74465-1007  
 918-456-5482 | 1-800-837-2869

Description	Quantity	Per
<b>ESTIMATE: Rehab (Housing Authority of the Cherokee Nation)</b>		<b>Claim #10676, Rebecca Winkler</b>
Approved		
<b>FLOORPLAN: Floorplan</b>		

**HVAC**

1 Heat Pump, Wall 2 Ton - Replace	1	EA
Install proper unit size to match home square footage. Install mini split system.		
2 Heat Strip, Air Handling Unit Up to 5 KW - Replace	1	EA
3 Dumpster 10 Yard	1	EA

**Windows**

4 Window, Double Hung, Vinyl Medium - Remove	4	EA
5 Window, Double Hung, Vinyl Medium - Replace	13	EA
Install single hung vinyl windows.		
6 Window, Single Hung, Aluminum Medium - Remove	9	EA

**Siding & Paint**

7 Siding, Lap, Hardboard 5" Exposure - Remove	860.00	SF
8 Siding, Lap, Hardboard 5" Exposure - Replace	860.00 (946.00)	SF
Includes 10% waste on material quantity.		
9 Vapor Barrier Shelter/House Wrap - Replace	860.00	SF
10 Siding - Prime & Paint	860.00	SF

**Ramp**

11 Wheelchair Ramp, Small - Remove	1	EA
12 Wheelchair Ramp, Small - Replace	1	EA
Straight run wheelchair ramp constructed from pressure treated lumber, screws, and labor to install. Posts are buried 4' below grade. Cost is based on a ramp that is 4' wide and has a 12' total run, with a 12" maximum rise, a 5'x5' top landing, and a concrete landing at grade level.		

**Ext. Doors**

13 Door, Entry, Prehung, Panel, Steel Good - Remove	1	EA
14 Door, Entry, Prehung, Panel, Steel Good - Replace	1	EA
15 Door, Storm/Screen, Aluminum/Vinyl, Good - Remove	1	EA
16 Door, Storm/Screen, Aluminum/Vinyl, Good - Replace	2	EA

**Bathroom**

**Length:** 7'7"      **Width:** 5'11"      **Height:** 8' Flat  
**Walls:** 216.00 SF      **Walls-sub:** 202.66 SF      **Walls-sub-cas-bsbd:** 170.14 SF  
**Doors:** 13.33 SF      **Windows:** 0.00 SF      **Openings:** 0.00 SF      **Missing Walls:** 0.00 SF  
**Floor:** 44.87 SF      **Ceiling:** 44.87 SF      **Perim (F):** 24.42 LF      **Perim (C):** 27.00 LF

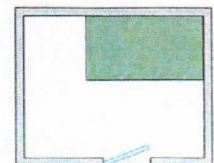

17 Door, Interior, Pre-Hung Lauan, HC, Flush - Replace	1	EA
Widen rough opening to accept 36" door.		
18 Shower Stall, Fiberglass Very Good - Replace	1	EA





Housing Authority of the Cherokee Nation  
 PO Box 1007,  
 Tahlequah, Oklahoma 74465-1007  
 918-456-5482 | 1-800-837-2869

Description	Quantity	Per
<b>ESTIMATE: Rehab (Housing Authority of the Cherokee Nation)</b>		<b>Claim #10676, Rebecca Winkler</b>
Approved		

Install low curb handicap shower.		
19 Faucet & Showerhead Single Valve, Good - Remove	1	EA
20 Grab Bar, Handicap, per LF - Replace	8.00	LF
Install four 2' grab bars.		
21 Faucet & Showerhead Single Valve, Good - Replace	1	EA
22 Bathtub, Cast Iron, Good - Remove	1	EA
23 Toilet, 2 Piece, Good - Remove	1	EA
24 Toilet, Handicap Very Good - Replace	1	EA
25 Cement Backer Board, Wall 1/2" - Remove	13.33	SF
26 Ceramic Wall, Thin Set 4", Good - Remove	13.33	SF
27 Exhaust Fan, With Light Good - Replace	1	EA
Vent fan w/light & heat.		

Bedroom			
<b>Length:</b> 13'6"	<b>Width:</b> 11'3"	<b>Height:</b> 8' Flat	
<b>Walls:</b> 372.67 SF	<b>Walls-sub:</b> 354.90 SF	<b>Walls-sub-cas-bsbd:</b> 337.41 SF	
<b>Doors:</b> 17.78 SF	<b>Windows:</b> 0.00 SF	<b>Openings:</b> 0.00 SF	<b>Missing Walls:</b> 0.00 SF
<b>Floor:</b> 139.20 SF	<b>Ceiling:</b> 139.20 SF	<b>Perim (F):</b> 43.33 LF	<b>Perim (C):</b> 46.58 LF

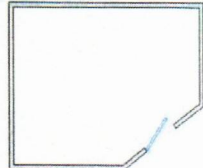

28 Door, Interior, Pre-Hung Lauan, HC, Flush - Replace	1	EA
Widen rough opening to accept 36" door.		
29 Linoleum, Sheet Good - Replace	15.47 (17.02)	SY
Includes 10% waste on material quantity.		
30 Base Molding, Stain Grade, 3" to 6" - Remove	43.33	LF
31 Base Molding, Stain Grade, 3" to 6" - Replace	43.33 (45.93)	LF
Includes 6% waste on material quantity.		