



HACN HOUSING REHAB SITE DIRECTIONS

Name: James Spears

Telephone: (918)316-2490

Address: 15187 W Grandview Rd
Tahlequah, OK 74464

County: Cherokee Year Built:

GPS Coordinates: 35.941083866611066, -95.02489895300221 Drive Time: 19

Mins



Directions: From Cherokee Nation, Turn right onto US-62/S Muskogee Ave and go 0.8 miles, At the traffic circle, take the 2nd exit and stay on US-62/S Muskogee Ave and go 2.3 miles, Turn left onto OK-51 W/OK-51BYP and go 3.1 miles, Turn left onto OK-51 Wand go 0.4 miles, Turn right onto N Bryant Rd and go 1.7 miles, Turn left onto W Grandview Rd and go 0.8 miles, Turn left and follow driveway to end.

Scotty Woodard
Cost Estimator/Inspector

8/19/24
Date



Housing Authority of the Cherokee Nation
 PO Box 1007,
 Tahlequah, Oklahoma 74465-1007
 918-456-5482 | 1-800-837-2869

Description	Quantity	Per
ESTIMATE: Roof (Housing Authority of the Cherokee Nation)	Claim #10678, James Spears	
Approved		
ROOFPLAN: Roofplan		

Beams

1 Beam, Rough Sawn Cedar, w/Finish 12" - Replace	6.00 (6.36)	LF
Includes 6% waste on material quantity. Cut porch roof support beams flush with the fascia to remove the rot present and stain or paint to match existing.		

Roof, Roof 2, Roof 3, Roof 4

Roof area: 2,736.13 SF **Squares:** 27.4 SQ **Soffit:** 469.14 SF
Eaves: 111.39 LF **Ridge:** 114.30 LF

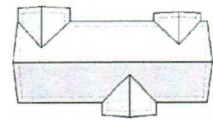

SHINGLES

2 Shingles, Laminated/Architectural Good - Tear Out	27.37	SQ
3 Shingles, Laminated/Architectural Good - Replace	27.37 (30.11)	SQ
Includes 10% waste on material quantity.		
4 Shingles, Starter Row, Continuous - Replace	111.39 (122.53)	LF
Includes 10% waste on material quantity.		
5 Ridge Cap Shingles, Fiberglass, Laminated - Replace	114.30 (125.73)	LF
Includes 10% waste on material quantity.		

UNDERLAYMENTS

6 Felt, 30LB - Replace	27.37	SQ
------------------------	-------	----

VENTS AND FLASHINGS

7 Drip Edge (Rake Only) Aluminum, Pre-Finish Color - Tear Out	133.52	LF
8 Drip Edge (Rake Only) Aluminum, Pre-Finish Color - Replace	133.52 (140.20)	LF
Includes 5% waste on material quantity.		
9 Drip Edge (Gutter Apron) Aluminum, Pre-Finish Color, 5" - Tear Out	111.39	LF
10 Drip Edge (Gutter Apron) Aluminum, Pre-Finish Color, 5" - Replace	111.39 (116.96)	LF
Includes 5% waste on material quantity.		
11 Valley Flashing, Aluminum - Tear Out	149.00	LF
12 Valley Flashing, Aluminum - Replace	149.00 (156.45)	LF
Includes 5% waste on material quantity.		
13 Flashing, Plumbing Vent Aluminum - Tear Out	3	EA
14 Flashing, Plumbing Vent Aluminum - Replace	3	EA

GUTTERS / DOWNSPOUTS / FASCIA

15 Gutter, Aluminum, K-Style 5" - Tear Out	111.39	LF
16 Gutter, Aluminum, K-Style 5" - Replace	111.39 (116.96)	LF
Includes 5% waste on material quantity.		
17 Downspout, Aluminum 2"x3" - Tear Out	40.00	LF
18 Downspout, Aluminum 2"x3" - Replace	40.00 (42.00)	LF
Includes 5% waste on material quantity.		

DEBRIS REMOVAL



Housing Authority of the Cherokee Nation
 PO Box 1007,
 Tahlequah, Oklahoma 74465-1007
 918-456-5482 | 1-800-837-2869

Description	Quantity	Per
ESTIMATE: Roof (Housing Authority of the Cherokee Nation)		Claim #10678, James Spears
 Approved		

19 No debris removal is needed for this estimate. The quantity is small enough that it can be discarded with local trash pick up.

20 Dumpster 20 Yard	1	EA
21 Roof Vent, Static, Box/Turtle, Aluminum - Replace	6	EA
22 Fascia - Prime & Paint	33.16	LF
23 Fascia, Wood Cedar 1" x 6" - Remove	33.16	LF
24 Fascia, Wood Cedar 1" x 6" - Replace	33.16 (34.82)	LF

Includes 5% waste on material quantity.

Total Bid
 Amount: _____
 Date: _____
 Contractor
 Signature: _____