



# HACN HOUSING REHAB SITE DIRECTIONS

---

**Name:** Pamela Iron

**Telephone:** (918)822-5232

**Address:** 23272 Hwy 82  
Park Hill, OK 74451

**County:** Cherokee      **Year Built:**       

**GPS Coordinates:** 35.8535432,-94.9897625      **Drive Time:** 2.4 miles,3 min

---

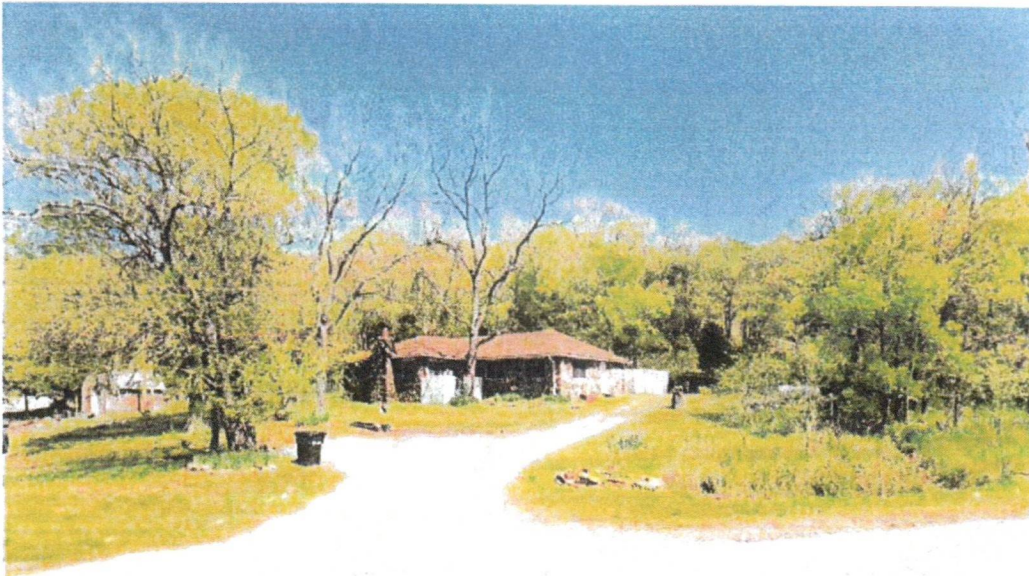

© Google

**Directions:** From Cherokee Nation, Head north on S Cotton Wood St towards Muskogee Ave 36 ft Turn Right onto US-62/S Muskogee Ave 0.6 mi At the traffic Circle, take the 1 st exit onto State Hwy 82 1.8 Destination will be the left

---

Eric Cheater  
Cost Estimator/Inspector

---

7/3/24  
Date

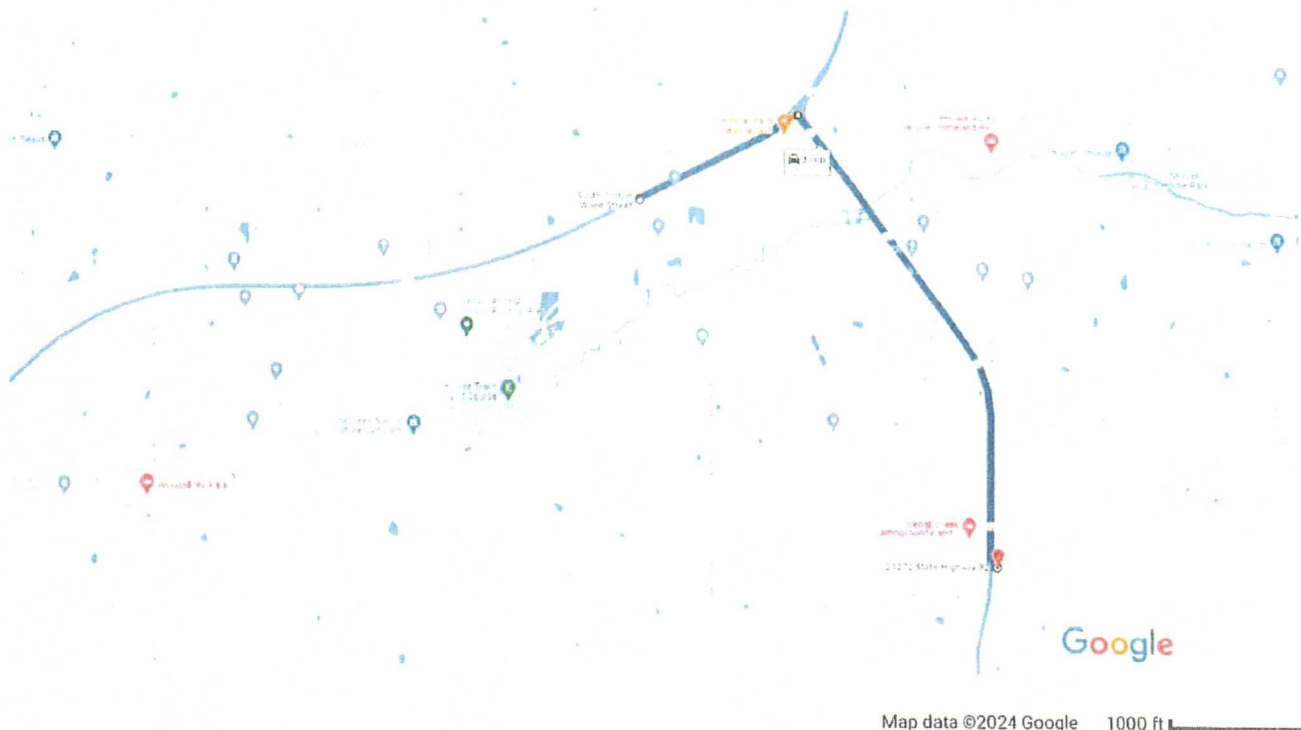

S Cotton Wood St  
Tahlequah, OK 74464

- ↑ 1. Head north on S Cotton Wood St toward S Muskogee Ave  
36 ft
  - ➔ 2. Turn right onto US-62/S Muskogee Ave  
0.6 mi
  - ↗ 3. At the traffic circle, take the 1st exit onto State Hwy 82  
1.8 mi
- i** Destination will be on the left

23272 State Hwy 82  
Park Hill, OK 74451

# WorkWrite-Up and Bid Document/By Trade

**Pamela Iron**

Contractor Name:

23272 Hwy 821 Park Hill, OK 7-4451  
 (918) 822-5232

Contractor Signature:

*This document must be signed to be a valid bid*

**PROJECT TYPE: Rehabilitation**

**Bid Due Date:**

Trade	Work Description / Comments	Gen. Spec.	Qty Unit	Item Bid
<b>Carpentry</b>				
1	<i>Area:</i> EXTERIOR Deck/Porch/Complete/2"x 6" Deck/Pressure Treated Wood. Install new porch deck, posts, framing, piers, guardrail, handrails, balusters and steps. All materials shall be pressure treated, and shall be fastened with recommended screws. <i>porch needs to be 8x10</i>	Div.# 6.FF	80 SF	<input type="text"/>
2	<i>Area:</i> BATHROOM #1 Door Opening/Widen/Interior/Widen interior door to 36" opening/Install new door/ pre-hung. Work shall include new door, framing, lockset, floor transition, paint and trim. <i>see door for swing</i>	Div.# 16.B. 2.	1 Ea	<input type="text"/>
3	<i>Area:</i> EXTERIOR Door/Exterior/6-Panel Steel/Pre-Hung/Replace. Replace exterior entrance door with new pre-hung-steel six panel door. Work shall include paint-both sides, lockset, deadbolt & peephole.	Div.# 8.A.	1 Ea	<input type="text"/>





Trade	Work Description / Comments	Gen. Spec.	Qty Unit	Item Bid
<b>Carpentry</b>				
4	<i>Area:</i> EXTERIOR Door/Exterior/Half-Glass/Pre-Hung Steel/Replace. Replace exterior entrance door with new pre-hung-steel two panel with 1/2 glass. Work shall include paint-both sides, lockset, deadbolt & peephole. <i>both doors need to be 3 o doors see doors for swing</i>	Div.# 8.A.	1 Ea	<input type="text"/>
5	<i>Area:</i> EXTERIOR Handrail/Pressure Treated Lumber. Install new handrail, pressure treated, 4" x 4" post, 2" x 4" stringer, 2" x 6" handrail. <i>build a handicap ramp off porch 25X4</i>	Div.# 6.V.	150 LF	<input type="text"/>
6	<i>Area:</i> EXTERIOR Siding/T-111/Remove and replace old siding with new siding /T-111,vapor wrap and trim.	Div.# 15	1520 SF	<input type="text"/>
7	<i>Area:</i> EXTERIOR Storm Door/Vinyl Clad/Install. Install new storm door, vinyl clad. Use Larson model 298-SS or written approved equal.	Div.# 8.B	2 Ea	<input type="text"/>
8	<i>Area:</i> INTERIOR Wall/Load Bearing/Demolish. Completely remove load bearing wall. <i>remove half wall in live room and the full wall at the end hallway</i>	Div.# 9.D.1.	43 LF	<input type="text"/>
<b>Drywall &amp; Finish</b>				
9	<i>Area:</i> DINING ROOM #1 Drywall/Ceiling/Remove drywall from ceiling. <i>remove wood planks from ceiling an drepair or replace sheetrock</i>	Div.# 9.D.1	152 SF	<input type="text"/>

Trade	Work Description / Comments	Gen. Spec.	Qty Unit	Item Bid
<b>Drywall &amp; Finish</b>				
10	<i>Area: LIVING ROOM #1</i> Drywall/Ceiling/Remove drywall from ceiling. remove wood planks from ceiling in living room and repair or replace sheetrock	Div.# 9.D.1	266 SF	<input type="text"/>
<b>Electrical</b>				
11	<i>Area: INTERIOR</i> Ceiling Fan, Light Kit /52"/Install new ceiling fan with light kit.	Div.# 13.D. 9.B	5 Ea	<input type="text"/>
12	<i>Area: INTERIOR</i> Cover Plate/Outlet/Install new outlet/ cover plate.	Div.# 13.D. 6.	25 Ea	<input type="text"/>
13	<i>Area: INTERIOR</i> Cover Plate/Switch/Install new switch & cover plate.	Div.# 13.D. 6.	6 Ea	<input type="text"/>
14	<i>Area: BATHROOM #1</i> Light Fixture, Switch & Circuit/ Bathroom. Install new bulb fixture over the vanity, switch, cover plate and circuit.	Div.# 13.D. 9	1 Ea	<input type="text"/>
15	<i>Area: BATHROOM #2</i> Light Fixture, Switch & Circuit/ Bathroom. Install new bulb fixture over the vanity, switch, cover plate and circuit.	Div.# 13.D. 9	1 Ea	<input type="text"/>

<i>Trade</i>	<i>Work Description / Comments</i>	<i>Gen. Spec.</i>	<i>Qty Unit</i>	<i>Item Bid</i>
<b>Electrical</b>				
16	<i>Area: BEDROOM #1</i> Light Fixture/Heat-Vent-Light/Install new bathroom light (100 watt), heater (1450 watt), vent fan (70 CFM) and switch. Fan shall be vented out of attic to code.	Div.# 13.D. 16	1 Ea	<input type="text"/>
17	<i>Area: BEDROOM #2</i> Light Fixture/Vent-Light/Install new bathroom light (100 watt), vent fan (70 CFM) and switch. Fan shall be vented out of attic to code.	Div.# 13.D. 16	1 Ea	<input type="text"/>
18	<i>Area: INTERIOR</i> Outlet/110V Duplex/15 Amp//Replace With GFCI. Replace existing 110 duplex outlet and cover with new GFCI outlet and cover.	Div.# 13.D.	4 Ea	<input type="text"/>
19	<i>Area: INTERIOR</i> Smoke Detector/Battery Operated/Install new smoke detector, battery operated (10 year lithium battery). All bedrooms and hallways adjacent to bedrooms. Use Firex #44015 or written approved equal.	Div.# 13.D. 11	6 Ea	<input type="text"/>
20	<i>Area: INTERIOR</i> Switch & Cover Plate/2-Way/Replace 2-way switch and cover	Div.# 13.D.	2 Ea	<input type="text"/>
<b>Flooring</b>				
21	<i>Area: BATHROOM #1</i> Flooring/ Install vinyl/waterproof/flooring planks. Install vinyl planks with 20 mil wear layer, 5.0 mil backing with 25 year residential warranty. Work shall include floor level, seal concrete, moisture resistant glue and top seal.	Div.# 9.L	48 SF	<input type="text"/>



<i>Trade</i>	<i>Work Description / Comments</i>	<i>Gen. Spec.</i>	<i>Qty Unit</i>	<i>Item Bid</i>
<b>Flooring</b>				
22	<i>Area: INTERIOR</i> Flooring/ Install vinyl/waterproof/flooring planks. Install vinyl planks with 20 mil wear layer, 5.0 mil backing with 25 year residential warranty. Work shall include floor level, seal concrete, moisture resistant glue and top seal.	Div.# 9.L	1600 SF	<input type="checkbox"/>
<b>Masonry &amp; Plaster</b>				
23	<i>Area: EXTERIOR</i> Brick/Rock/ & Mortar/Demolish. Demolish brick, rock and mortar wall. <b>and remove all the way down to the studs to see whats going on with it</b>	Div.# 4.G.	1520 SF	<input type="checkbox"/>
<b>Paint &amp; Finish</b>				
24	<i>Area: INTERIOR</i> Paint/ Interior of House/Ceilings, walls/Paint Two coats. Work shall include minor repairs to surfaces. SF=Area under roof. Match existing Texture.	Div.# 9.N.3	5600 SF	<input type="checkbox"/>
<b>Plumbing</b>				
25	<i>Area: BATHROOM #1</i> Commode/High Rise/Handicap /Replace commode with new high rise/Handicap commode with Seat & two (2) grab bars. Include new shutoff, supply line and wax ring. Examine condition of the flange and report if damaged. Consult owner for location of grab bars	Div.# 16.C.	1 Ea	<input type="checkbox"/>
26	<i>Area: BATHROOM #1</i> Lavatory Sink & Faucet/ADDAWall Hung. Install new wall hung lavatory sink supply lines, drain lines, shutoffs, escutcheon plates, insulation for all water and drainlines. Use Orion #52000020 sink, Delta model 520-WFMPU faucet or written approved equal.	Div.# 16.C.	1 Ea	<input type="checkbox"/>

Trade	Work Description / Comments	Gen. Spec.	Qty Unit	Item Bid
<b>Plumbing</b>	27 <i>Area:</i> <b>BATHROOM #1</b> Shower/Handicap/Pre-Fab/Install new 34" x 60" x 74" /Pre-fab 3 or 4 piece/60" x 34" x 74" with 3-grab bars, fold down shower seat, and pressure balanced shower valve with glide bar. Includes all necessary Plumbing.	Div.# 16.C.	1 Ea	<input type="text"/>
<b>Site Work</b>	28 <i>Area:</i> <b>FOUNDATION</b> Foundation/Grade for Drainage. Remove dirt at foundation and grade to provide proper drainage away from foundation and clearance of finished floor over finished grade.	Div.# 2.F.	1600 SY	<input type="text"/>
<b>All construction shall be in accordance with local codes, manufacturers' recommended installation procedures, good quality workmanship practices, General Specifications and Lead-Based Paint requirements when applicable. Conflicts between requirements will be resolved by Contractor with the more stringent requirement. Contractor awarded the job will be responsible for conducting safe work practices that comply with OSHA Construction Standards for Asbestos Workers. Asbestos report, where required, will be attached if areas tested are 1% or greater. See attached Asbestos Sampling Report for location and testing of Planned Work Activities.</b>				<b>Total:</b> <input type="text"/>