

# HACN HOUSING REHAB SITE DIRECTIONS

---

**Name:** Ruben Ellis Jr.

**Telephone:** (918)843-9299

**Address:** 5774 E Hwy 64  
Warner, OK 74469

**County:** Muskogee

**Year Built:** 1970

**GPS Coordinates:** 35.493905256459016, -95.2867803344724

**Drive Time:** 47

Mins

---



**Directions:** From Cherokee Nation, Turn left onto US-62 W/S Muskogee Ave  
Continue to follow US-62 W for 19.9 miles, Use the right lane to merge onto OK-  
165 S/OK-351 via the ramp to Ft Smith  
Continue to follow OK-351  
Toll road for 21.6 miles, Take exit 55 to merge onto US-64 W toward Warner for  
6.7 miles, destination will be on the right

---

Scotty Woodard  
Cost Estimator/Inspector

8/2/24  
Date



Housing Authority of the Cherokee Nation  
 PO Box 1007,  
 Tahlequah, Oklahoma 74465-1007  
 918-456-5482 | 1-800-837-2869

Description	Quantity	Per
<b>ESTIMATE: Rehab (Housing Authority of the Cherokee Nation)</b>	<b>Claim #10656, Ruben Ellis, Jr.</b>	
Approved		
<b>FLOORPLAN: Floorplan</b>		

**Plumbing**

1 Plumbing, Rough In, Bathtub/Shower, PEX - Replace	1	EA
2 Plumbing, Rough In, Sink, PEX - Replace	2	EA
3 Plumbing, Rough In, Toilet, PEX - Replace	1	EA
4 Plumbing, Rough In, Washing Machine, PEX - Replace	1	EA
5 Plumbing, Rough In, Water Heater, PEX - Replace	1	EA
6 Toilet, 2 Piece, Good - Remove	1	EA
7 Toilet, Handicap Very Good - Replace	1	EA
8 Trucking & Hauling, 1/2 Ton	1	LD

**Hvac**

9 Condensing Unit 2 1/2 Ton - Remove	1	EA
10 Condensing Unit 2 1/2 Ton - Replace	1	EA
Install proper unit size to match home square footage.		
11 Furnace, Forced Air, Electric Up to 10 Kilowatt - Remove	1	EA
12 Furnace, Forced Air, Electric Up to 10 Kilowatt - Replace	1	EA
Install proper unit size to match home square footage.		
13 Air Handling Unit 3 Ton - Remove	1	EA
14 Air Handling Unit 3 Ton - Replace	1	EA
Install proper unit size to match home square footage.		

**Kitchen**

**Length:** 23'2"      **Width:** 15'3"      **Height:** 8' Flat  
**Walls:** 614.66 SF      **Walls-subs:** 614.66 SF      **Walls-subs-cas-bsbd:** 592.26 SF  
**Doors:** 0.00 SF      **Windows:** 0.00 SF      **Openings:** 0.00 SF      **Missing Walls:** 0.00 SF  
**Floor:** 263.29 SF      **Ceiling:** 263.29 SF      **Perim (F):** 76.84 LF      **Perim (C):** 76.84 LF

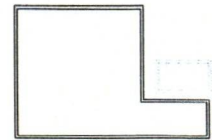

15 Underlayment 3/4" CDX Plywood, Tongue & Groove - Remove	32.00	SF
16 Underlayment 3/4" CDX Plywood, Tongue & Groove - Replace	32.00 (35.20)	SF
Includes 10% waste on material quantity.		
Match existing subfloor.		
17 Linoleum, Sheet Good - Remove	29.25	SY
18 Linoleum, Sheet Good - Replace	29.25 (32.18)	SY
Includes 10% waste on material quantity.		



Housing Authority of the Cherokee Nation  
 PO Box 1007,  
 Tahlequah, Oklahoma 74465-1007  
 918-456-5482 | 1-800-837-2869

Description	Quantity	Per
<b>ESTIMATE: Rehab (Housing Authority of the Cherokee Nation)</b>		Claim #10656, Ruben Ellis, Jr.
Approved		

Living Room			
<b>Length:</b> 15'10"	<b>Width:</b> 19'3"	<b>Height:</b> 8' Flat	
<b>Walls:</b> 561.34 SF	<b>Walls-sub:</b> 561.34 SF	<b>Walls-sub-cas-bsbd:</b> 540.88 SF	
<b>Doors:</b> 0.00 SF	<b>Windows:</b> 0.00 SF	<b>Openings:</b> 0.00 SF	<b>Missing Walls:</b> 0.00 SF
<b>Floor:</b> 304.79 SF	<b>Ceiling:</b> 304.79 SF	<b>Perim (F):</b> 70.16 LF	<b>Perim (C):</b> 70.16 LF



19 Linoleum, Sheet Good - Remove	33.87	SY
20 Linoleum, Sheet Good - Replace	33.87 (37.26)	SY
Includes 10% waste on material quantity.		

Hallway			
<b>Length:</b> 6'	<b>Width:</b> 3'3"	<b>Height:</b> 8' Flat	
<b>Walls:</b> 148.00 SF	<b>Walls-sub:</b> 148.00 SF	<b>Walls-sub-cas-bsbd:</b> 142.60 SF	
<b>Doors:</b> 0.00 SF	<b>Windows:</b> 0.00 SF	<b>Openings:</b> 0.00 SF	<b>Missing Walls:</b> 0.00 SF
<b>Floor:</b> 19.50 SF	<b>Ceiling:</b> 19.50 SF	<b>Perim (F):</b> 18.50 LF	<b>Perim (C):</b> 18.50 LF

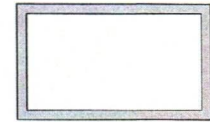

21 Linoleum, Sheet Good - Remove	2.17	SY
22 Linoleum, Sheet Good - Replace	2.17 (2.39)	SY
Includes 10% waste on material quantity.		

Total: \_\_\_\_\_  
 Date: \_\_\_\_\_  
 Contractor Signature: \_\_\_\_\_